

REKHA[®]

A tradition of precision



C N C T U R N I N G C E N T R E

The Precut -200 is a precise, price economic CNC Turning Precision Machine For best job outputs and ancillaries. The Precut-200 is having high operating efficiency contribution to higher utilisation of tools, power, space and time and also built to have parameters, continues surface speed and keep non-cut time to the minimum. The machine elements viz-a-viz ball screw, bearings CNC systems as well as drive have been selected from the best products available in country. The machine is designed and developed by a dedicated team of experienced skilled craftsmen and under guidance of technical experts.

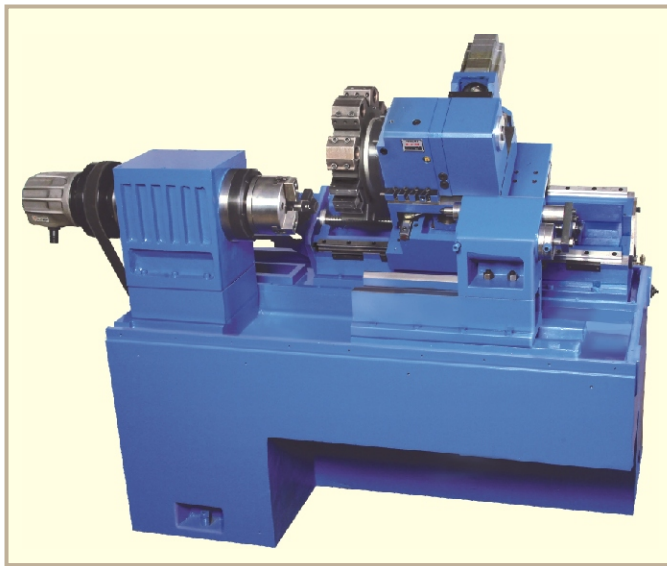

BED

The bed is best grain grade 25 cast iron casting. It is well ribbed to provide rigidity and the bed is designed for smooth and easy chip flow and removal.

AXES

X and Z-axes features precision ball screws supported in both ends. To ensure stability and fully protected the guide ways are well spaced. Automatic metered lubrication is provided to all the Guide ways and ball screws.

SPINDLE

The spindle is assembled and tested in the controlled clean AC room. the super precision angular contact bearings are used in front and rear of the spindle. The bearings are grease lubricated for longer life.

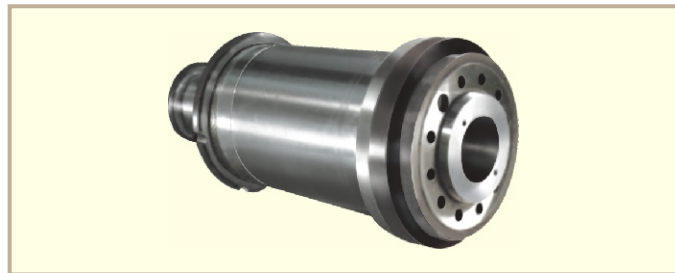

TAIL STOCK

The tail stock is supported on V and flat guide ways.

ELECTRICAL SYSTEM

The electrical elements uses in the machine are of highly reliable and globally accepted and sub systems, siemens CNC systems, siemens AC digital spindle motor with controller and siemens axes motor with controller are offered of standard products.

POWER - TORQUE DIAGRAM

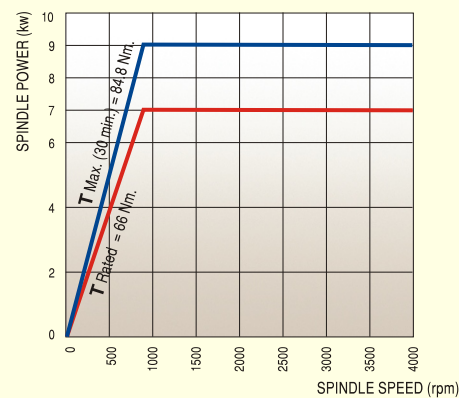

CNC SYSTEM : SIEMENS-SINUMERIC 802D

FEATURES :

- Simultaneously 2 Axes Control
- Process - Oriented Cycles
- Thread Cutting Cycles
- Direct Drawing dimension Programming
- Pitch Error & Backlash Compensation
- Auto Referencing
- Constant Surface Speed Control
- 256 KB User Memory
- Inch / Metric Switch able
- Tool Nose Radius Compensation
- Part Count, Time Count & Working Time
- G Code Compatibility with other NC Builders
- Graphic Simulation
- Electronic Hand Wheel

STANDARD FEATURES

- AC spindle motor
- AC Servo Digital Drive for axis
- L. M. Guide ways
- Hydraulic Chuck
- 8 St. Bi-directional SERVO Turret.
- 3 nos. Boring bar holder
- 1 nos. Facing tool holder
- Auto & Manual Coolant System
- Centralized & Programmable Lubrication
- Electrical with quality devices & panel with A. C.
- Tailstocks
- Set of Sleeves

OPTIONS :

- Chip Conveyor
- Tool Life Management
- Programmable Tail Stock (Live)



INTERFERENCE

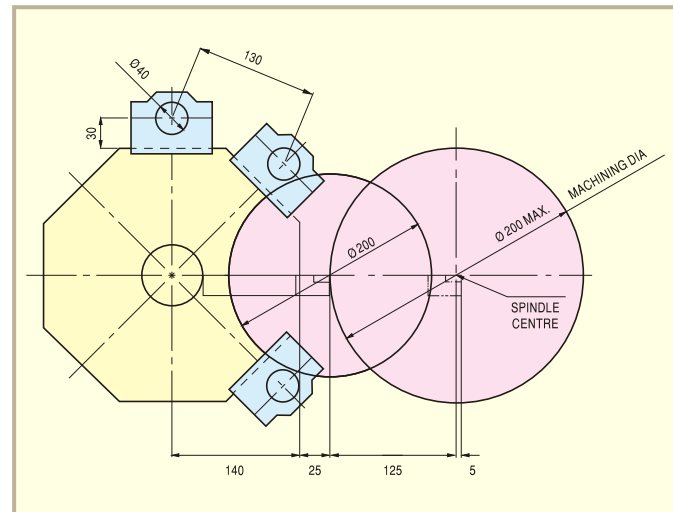

MACHINING RANGE

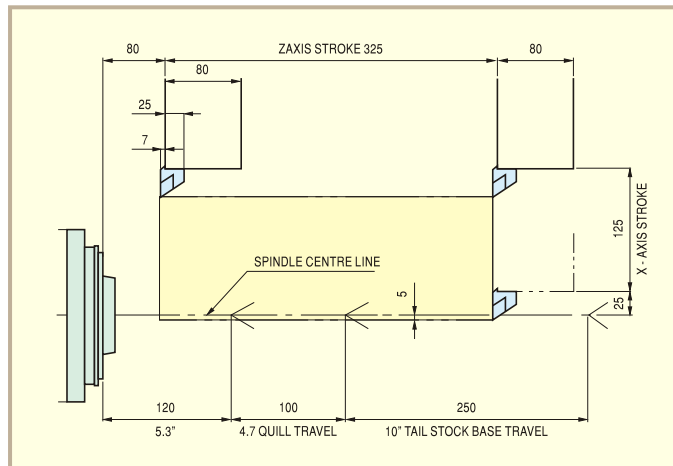

SPECIFICATIONS

CAPACITY

Swing over bed	400 mm
Swing over carriag	200 mm
Distance between centers	425 mm
Maximum turning dia	200 mm
Maximum turning length	325 mm

MAIN SPINDLE

Spindle nose	A2-5 mm
Spindle bore	38 mm
Maximum bar capacity	25 mm
Chuck size	165 mm
Front bearing bore	70 mm

SPINDLE DRIVE

AC servo motor	7.5/9 kw (continuous rating / 30 m/min. rating)
Speed range	0 - 4000 rpm
Full power speed range	700-2500 rpm

AXES SLIDES

X - axis stroke	125 mm
Z - axis stroke	400 mm
Rapid traverse rate : X - axis	20 mtr /min
Rapid traverse rate : Z - axis	20 mtr /min
Ball screw dia x pitch X	32 x 10 mm
Ball screw dia x pitch Z	32 x 10 mm
Rated Torque X	6 Nm
Rated Torque Z	6 Nm

TAIL STOCK

Quill diameter	50 mm
Quill stroke	100 mm
Taper in quill	MT-3
Tailstock base travel	250 mm

TURRET

No. of stations	8
Maximum boring bar dia	40 mm
Tool cross section	25 x 25 mm

WEIGHT (approx) 3200 kg

DIMENSIONS (approx) 2100 x 1330 x 1615 mm

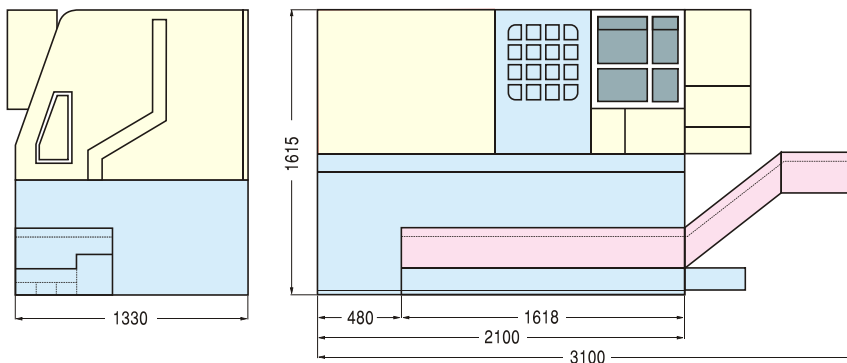

Manufactured by

REKHA INDUSTRIES

Plot No. 7-C & D, Udhogynagr, Surendranagar - 363 001 (Gujarat)

Phone (02752) 231311 / 234311 Fax : 91-2752-234311

Email : rekha_ind_ad1@sancharnet.in / rekha_ind@dataone.in

Web : www.rekhagrinding.com

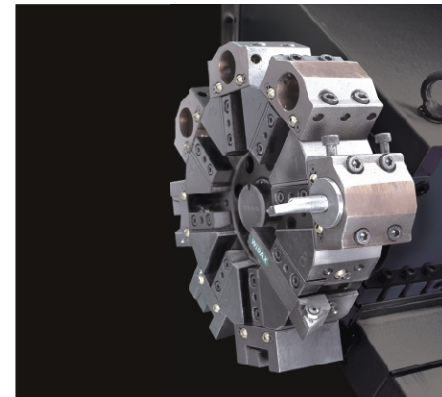

★ With appropriate work holding.
Note : Owing to continuous upgrading of our products,
 The specifications are subject to change without notice.